



## Owners Mannual for I C S Quality Tubs

I C S Quality Baths is a major supplier of many types of bathtubs and care instructions vary from type to type. Please identify your tub type from the following class of tub:

For general cleaning all types of tubs can be cleaned with liquid kitchen and bath cleaners that are non- abrasive. Use cotton terry cloth, clean sponges, or solid white paper towels to apply the cleaner. Do not use chemicals or abrasives on your tub until you check the following specific instructions for each tub type.



**Vaccum Formed Acrylics:**

**No Painted Surfaces**

**2018 pg2**

**Drop-in or skirted Tile Flanged tubs    All white or biscuit acrylic tubs**

|                                       |  |
|---------------------------------------|--|
| <b>Two Piece acrylic Freestanding</b> | <b>All white or biscuit acrylic tubs</b> |
| <b>Acrylic Claw Foot Freestanding</b> | <b>No custom painted exteriors</b>       |
| <b>Acrylic Pedestal Freestanding</b>  | <b>"</b>                                 |
| <b>Classic Skirted Freestanding</b>   | <b>"</b>                                 |

- 1) General cleaning use most commercial kitchen and bath cleaners on a weekly basis.
  - 2) Glue and hard to remove sticky materials and paint overspray use car polishes , auto waxes or silicone spray wax designed for exterior car use. Use alcohol only if you are sure your tub has no painted surfaces.
  - 3) Fine surface scratches buff with auto polishing compound . Acrylic is thicker at top of tub, thinner in bottom !
  - 4) Scratches you can feel with fingernail sand out the scratch with 600 grit sand paper followed by 2000 or finer sand papers and polish with auto polishing compound to restore shine. Tub interior only , unless you are sure your tub has no paint.
  - 5) Gouges, cracks, spots where you can see the fiberglass underlayment? Call a tub repair professional to repair or replace tub.
- 

**Seamless Acrylic Freestanding tubs and Acrylic tubs with Custom Painted Exteriors;                      Special Custom Exterior Colors:**

**I C S does not paint the interior of any tub.**

**The exterior custom colors are basically car paint. Clean carefully with liquid bath cleaners and never use alcohol or any chemicals. Auto polish and wax are best for stubborn stains or sticky substances on the tub.**

**Seamless acrylics are chemically welded, filed , sanded and painted on the exterior near the top of the tub. Care should be taken in this area of exterior, like a custom color.**

**Scratches , Gouges, deep scrapes cannot be sanded out and will require a painting professional to restore the original appearance of the exterior of your tub.**

## **Sprayed Baked Gel Coat Walk-in tubs;**

pg 3

Same instructions as Acrylic above . Todays Gel Coats are much improved and often hold up as well as acrylic and over these advantages;

Thickness is consistant over the entire tub, while vaccum formed acrylics are thicker at the top and thinner at the bottom of tub.

Gel Coat is easily replaced for deep gouges where acrylic, never being a liquid cannot be replaced after tub is made.

Deep tub designs are best suited for baked hardened gel coats.

---

## **Enameled Cast Iron;**

**A time tested favorite;**

The interior of your cast iron tub is was made dropping dry porcelain on a firey hot tub and the finish melted , thus the inconsistant thickness and slight runs are common.

The exterior of your tub was painted with quality car paints. Some finishes have clear coats over basic paint. Some finishes have multible layers of paint.

Clean the inside of your tub using instrcutions above for Acrylic tubs and you may use alcohol only in the interior and not tub edges or the outside.

Any major damage to the exterior will require a painting professional to repair.

Minor surface scratches can be poished out with auto polish on the interior only. For the exterior fine car polishes and waxes are best.

Chipped porcelain can be filled and painted over by a repair professional. There are comerically available kits from Hardware store that can cover small repairs.

---

## **Cast Solid Surface tubs;**

**Solid thick color all the way;**

Solid surface is poured from stone and resins. The surface is more pourus than other finishes but can be sanded to clean stubborn stains with 300 to 800 grit foam sanding blocks. I C S uses Simple green, Mean Green, Purple Power, etc with rags and foam sanding blocks. Minor scratces and sometimes deep scratches can be sanded out becuse there is a lot of material to work with. Polishing with car polish is recomended periodically.



## Water Jetted Tubs

pg 4

Jetted tubs operate from on-off buttons which turn pump on with a quick push of button. A rubber balloon in the body of on-off is compressed and a puff of air exits at pump, actuating a pressure switch.

Some jetted tubs have a variable speed control with max. & min. settings which allow air to bleed into pump impeller reducing all jet pressures.

ICS uses adjustable jets where possible. Adjust the flow by turning the face. Some jets will turn in a circle 360 degrees while others will hit a stop position to left or right. Turn by hand only !

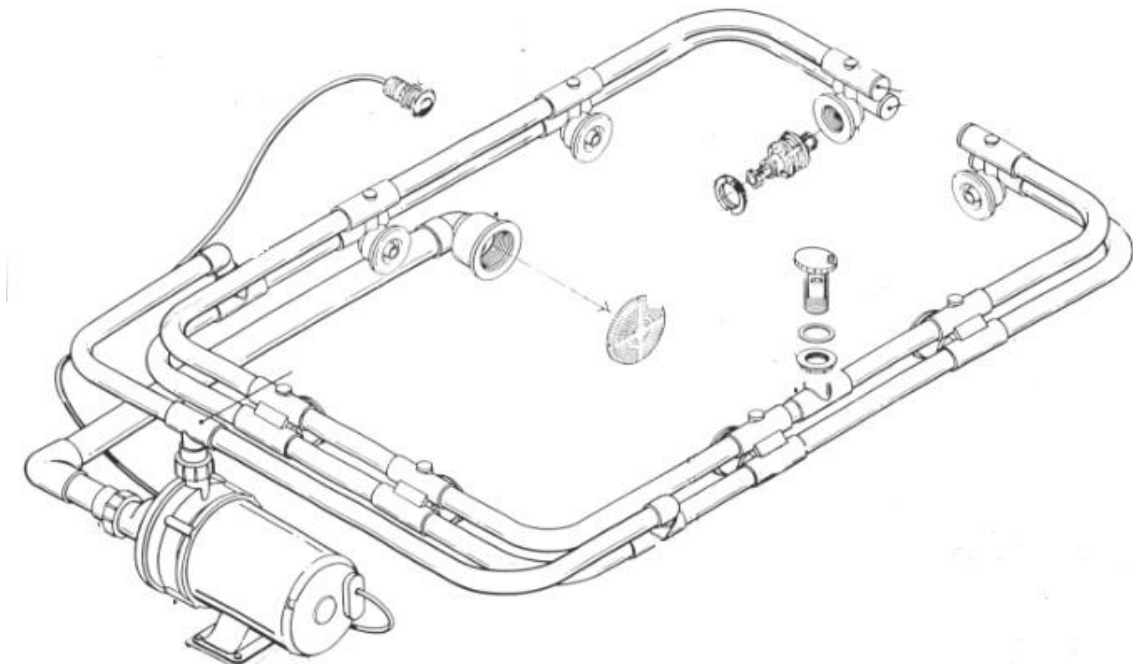

**Typical Jetted tub System**

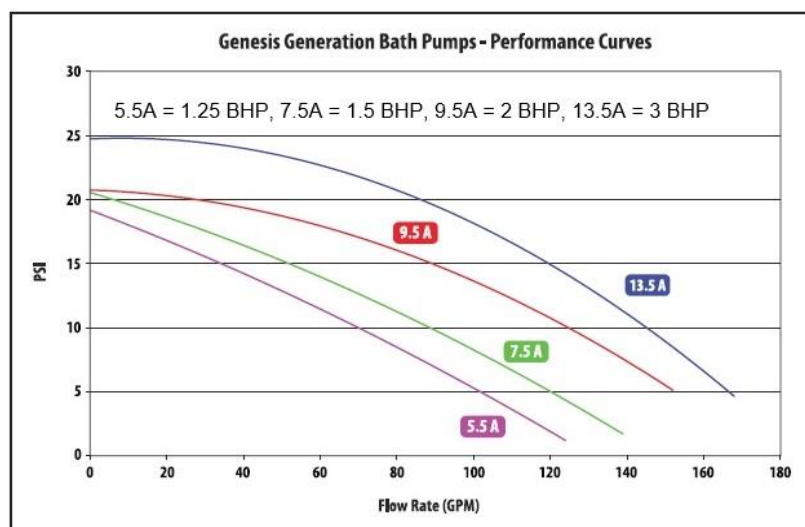
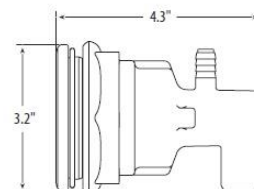
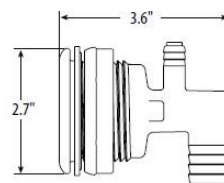

Water enters the jetted tub system from the jets and suction fitting and is circulated by the pump.  
Soap, body oil, dirt, and scum accumulate in pipes during use and is normal.

Use of bubble baths and bath salts will void pump warranty and build up will occur in lines and fittings. I C S recommends limited use of bubble baths and scented products & no use of salts.

Optional Heaters 120 V 1500 watt or Friction styles are not user adjustable and are automatic.

Pour 1/2 cup of bleach into a half tub of water, covering the jets with squirt of dawn liquid and run pump for half hour, every 3 months.

## ICS Air Jetted Tubs

pg 6



**Typical Air Jetted Drop-in tub**

**Sidewall Mounted Jets**

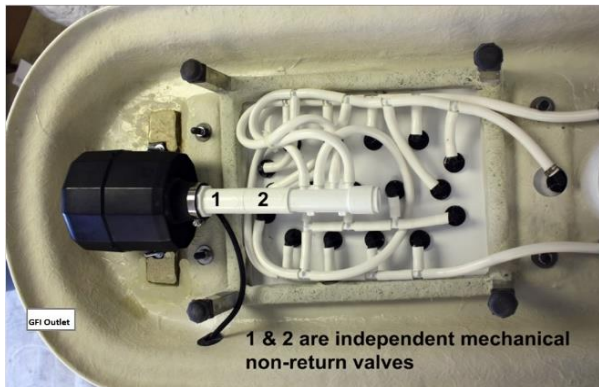

**Pedestal Mounted Blower**



**Tub Mounted Blower**



**Real Air Jets, not drilled holes**

**No routine maintenance is required for air tubs.**

**200 watt heater inside blower is automatic.**

**Push button on-off cycles blower thru speeds**

**Auto purge runs jets 5 minutes, 20 minutes after use.**



I C S Walk-in tubs use a rubber gasket to seal the door that is pressure operated by the door handle. Keep this gasket clean with warm soak like Dawn dissolved in water, using a soft cloth.

There are a few special instructions for walk-in baths. The hardened marine graded gel coat finish will last for many years of normal use. Application on car Polish to finish twice a year will preserve the finish from oxidation and extend life. Do Not polsih or wax Floor!

Always use a non slip floor mats outside the door for extra safety from a fall.



**Tub Installation; Tub Creaks or pops when standing in empty tubs.**

Drop-in tubs are set in concrete and concrete shrinks when cured. If noise goes away when tub is full of water ,do nothing. Placing paper or plastic between concrete & tub would have prevented the noise, but once tub is set I C S recommends leaving tub set as is.

Freestanding tubs have adjustable legs designed to support the weight of tub , water, & bather. If legs were not adjusted properly, fiberglass is bending to compensate for the weight. Remove tub, flip upside down and adjust legs level with or slightly below tub base or skirt. Drain height is important as tub will rock back and forth on a high drain hub.

**Walk-in tub gasket leaks;**

Clean gasket per instructions above. If problem persists check tub for level so weight is distributed evenly. If door still leaks call ICS for a thicker door cam to tighten door.

**Whirlpool Jetted tub motor or air blower does not operate;**

**Reset GFCI**      Ground Fault Circuit Interrupter tripped by power surge or Lightning.  
Equipment not plugged in or power outage. Check power @ recept plug in.

Check connection of air hose from on-off button actuator to the equipment. A loose hose will not carry air sufficient to trip air switch.

**One or more jets do not operate properly;**

Turn the face of the adjustable water jets to activate flow. If equipped with variable pump speed control turn to max. before adjusting adjustable jets.

Air jets are not adjustable and will vary slightly based on location of jet and the location of bather covering some of the air jets.

**Water pump surges and pulsates, stops pumping**

Modern suction devices use safety air release to stop pressure from suction fitting. If bather blocks suction with leg or objects the pump stops pumping to prevent drowning if hair etc, is caught in the suction fitting by pump pressure.